

Telescopic Loading Bellows

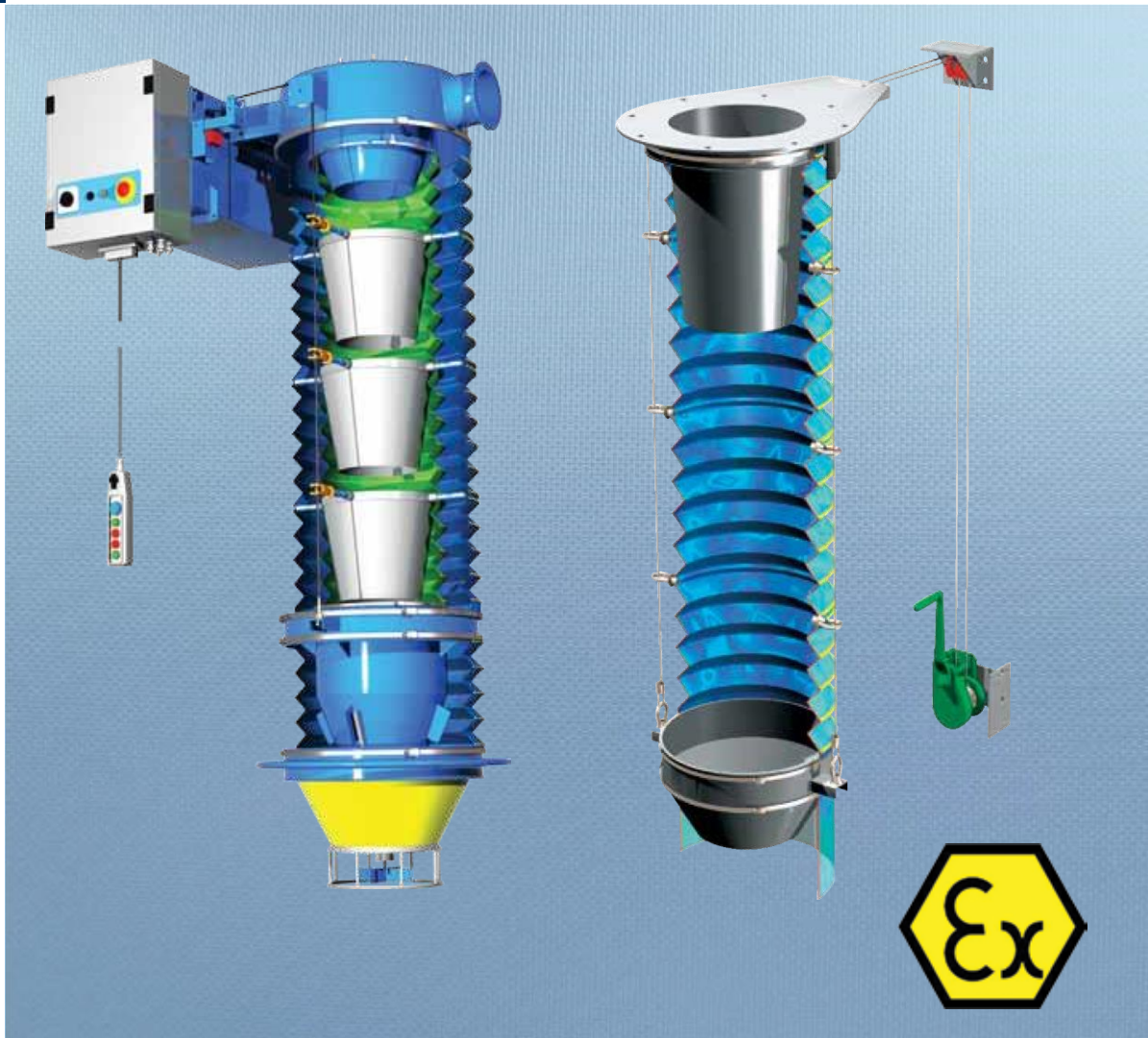

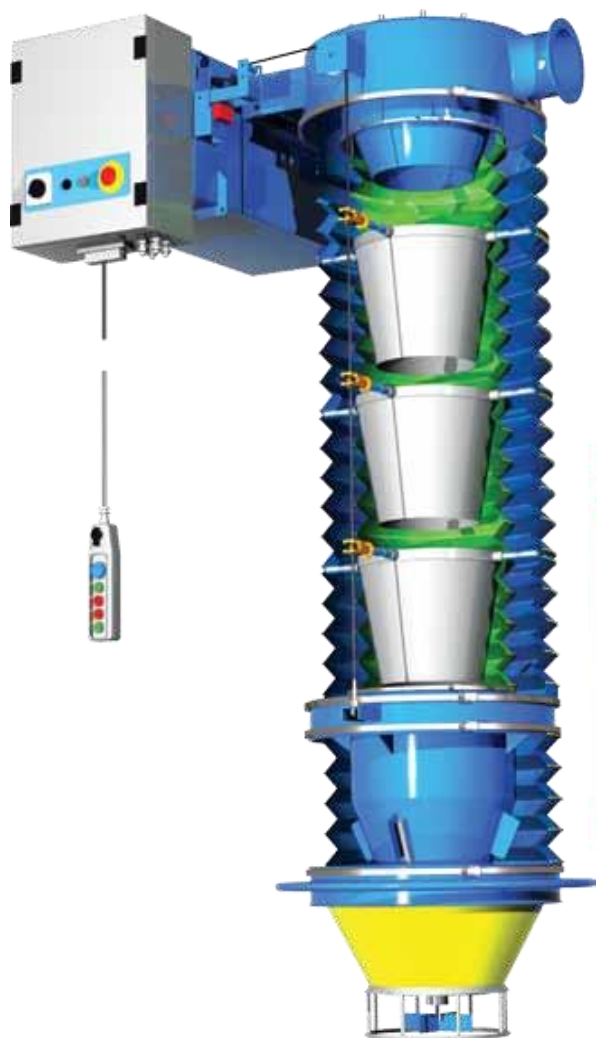

2 Upper Head with Motorization



All moving parts protected from corrosion and shocks.
Two single-seat winding pulleys ensure stability and precision in both extension and retraction.

Upper/Lower Position limit switches.
Slack-cable device limit switch.

3 Chute Models

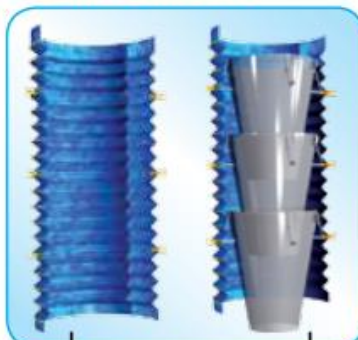

"A0" SINGLE BELLOW

"AB" SINGLE BELLOW WITH
INNER BIG CONES

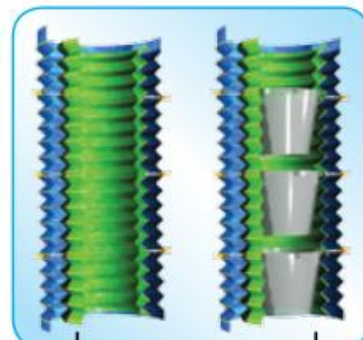

"B0" DOUBLE BELLOWS

"BA" DOUBLE BELLOWS WITH
INTERNAL STEEL CONES

1 Bottom Outlet Cone with Sint Coating



At the lower end of a loading bellow for closed tanker, a polymer-coated SINT cone with special sealing qualities is provided for dustproof connection to the tanker's hatches.

This cone outlet can be equipped also with an anti-waste device which acts as a dust proof stopper as the loading bellow is being raised.

Loading Bellow for Tanker Truck

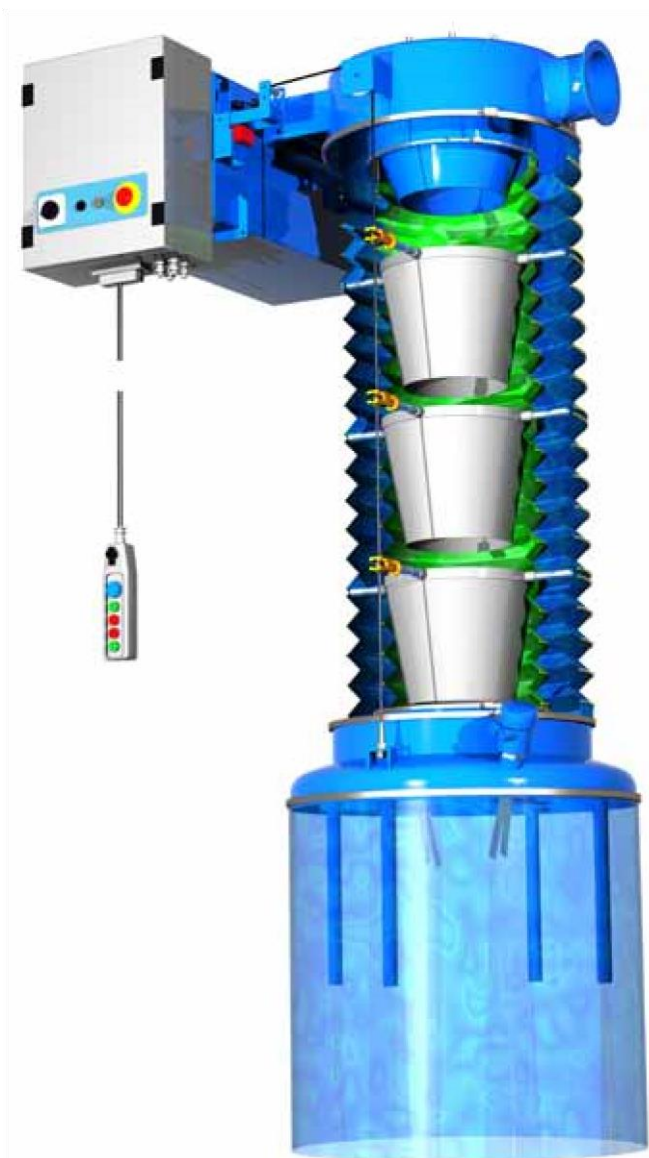

2 Upper Head with Handle Winch

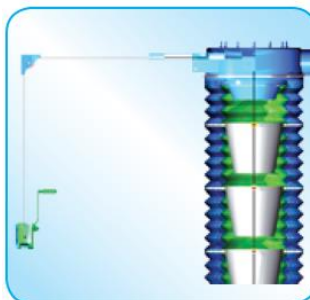

Remote Handle Winch

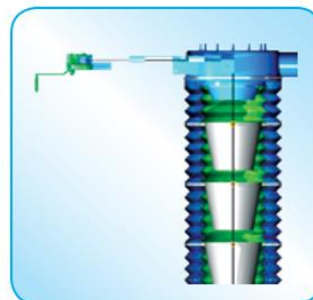

Attached Handle Winch



HYPALON-NEOPRENE BELLOWS

- Flexible Neoprene bellows coated with Hypalon® offers high resistance to atmospheric agents, abrasion and high temperature, thus making the loader highly durable.



FOOD-GRADE POLYESTER

- Suitable to be in contact with food products
- Antistatic



KEVLAR BELLOWS

- Suitable for high and low temperatures

1 Bottom Outlet Dust containing Skirt



At the lower end of the loading bellow, a special Dust Containing Skirt sealing is provided for settling on the skip or pile to prevent spreading the dust in the environment.

A double level indicator is provided to assure a constant detection of the raising discharging material, allowing an automatic raise of the bellow and keep the skirt always in contact with the piling material preventing the dust to escape.

ZN

Telescopic Loading Bellows



IDEAL COMBINATION OF ATTRACTIVE PRICE, SIMPLICITY AND QUALITY FOR DUST-FREE TANKER LOADING

ZN Loading Bellows are suitable for continuous duty at a maximum capacity of 250 m³/h (147 cfm) with a 300 mm inlet.

The upper head has a simple, compact design without dust suction inlet. At the lower end the ZN Loading Bellows is provided with a metal cone and a skirt which prevents dust emission during discharging.

Bellows retraction is controlled by a remote handle winch and guide pulley.

Features

- Inlet Diameter: 300mm (12 in)
- Maximum Capacity: 250 m³/h (147 cfm)
- Maximum Extension: 4 metres (13 ft)
- Working Temperature: from -40 up to 150°C (-40 up to 300°F)
- Manually operated with remote handle winch and guide pulley
- 2 off external extension/retraction cables enabling free movement of the loading bellows; wear-resistant
- Manufactured from carbon steel and 304/316 Stainless Steel
- Single bellows, 400 mm diameter (16 in), available in Hypalon®/Neoprene, food-grade polyester or Kevlar®
- ATEX-version for Zone 20-22 and Zone 20-21 available

Overall Dimensions

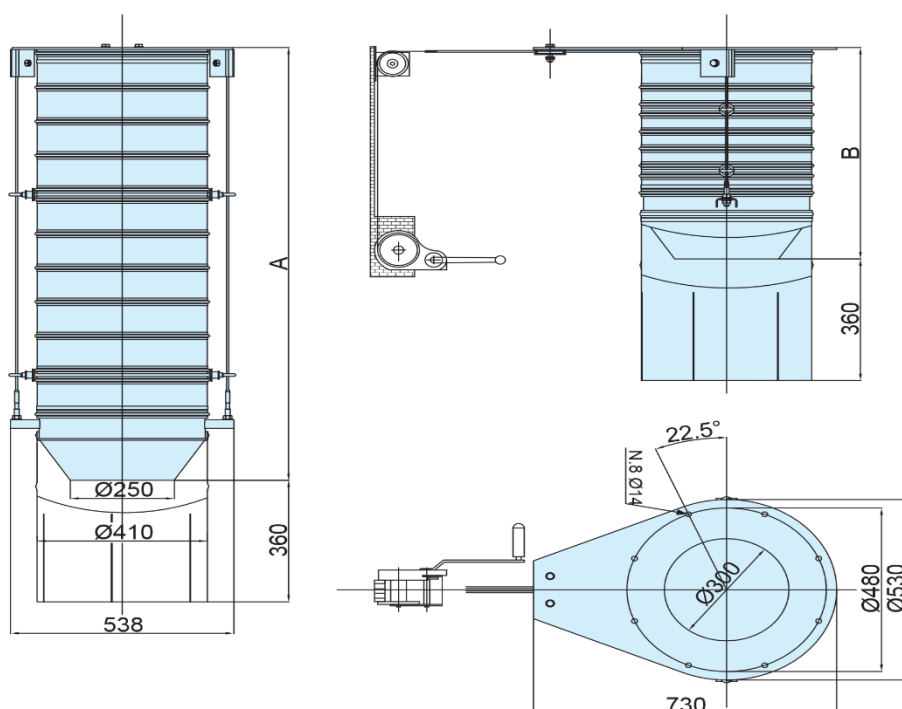

Order Modules	A	B
5	900	400
7	1,170	420
10	1,470	470
12	1,700	450
15	1,970	470
17	2,270	520
20	2,500	500
22	2,770	520
25	3,070	570
27	3,370	620
30	3,670	670
32	3,970	720
35	4,270	770